

**LUBING**  
POULTRYTEC

**DIRT REMOVAL BELT  
FOR  
CONVEYOR SYSTEMS**



# DESIGN

ASSEMBLIES	TYPE		
	350	500	750
Drive unit	Art. 187 006 20 00	Art. 185 006 20 00	Art. 188 006 20 00
Holder for dirt removal belt	Art. 187 700 04 00	Art. 185 700 04 00	Art. 188 700 04 00
End units	Art. 187 006 24 00	Art. 185 006 24 00	Art. 188 006 24 00
Plastic fabric belt	Art. 75 02 013	Art. 75 02 011	Art. 75 02 012
Motor 0,18 kW	Art. 50 03 012	Art. 50 03 012	Art. 50 03 012

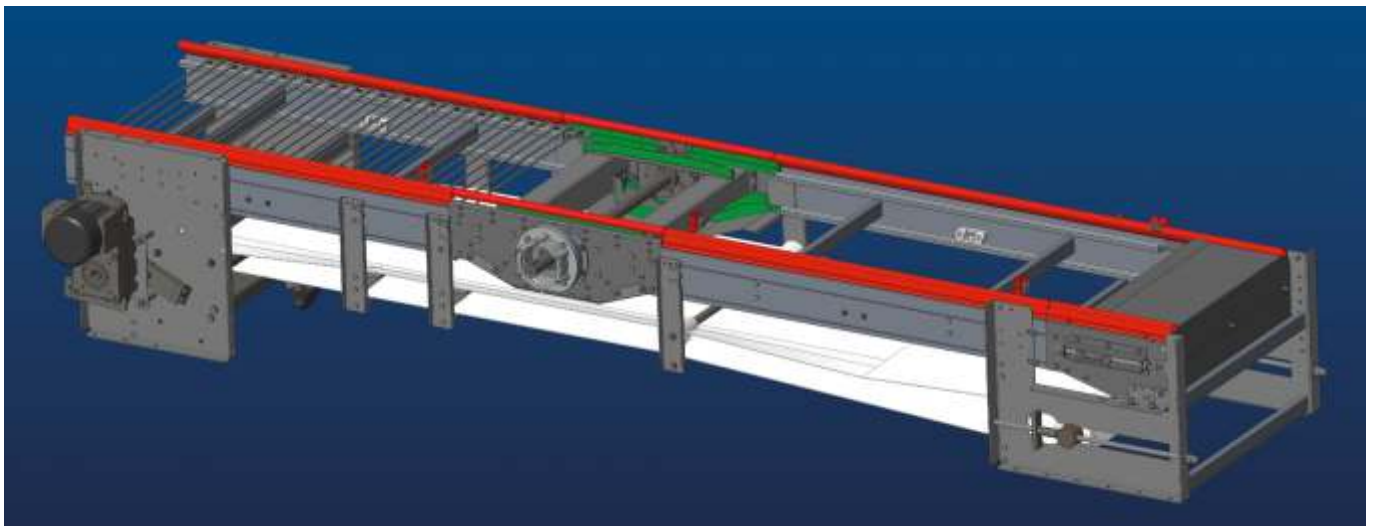

The dirt removal belt for the curve conveyor consists of the drive unit as well as the holders for the plastic fabric belt and the end unit. The belt speed of the dirt belt is 3.9 m /min. Special voltages on request.

## ➤ ADVANTAGES

- » Dirt and soft-shell eggs are collected under the LUBING conveyor system. This avoids time-consuming cleaning of the floor or even the dirt collection plates in the conveyor system.
- » Conveys the soft-shell eggs to the drive side so that they are discharged at a defined point by the integrated scraper.
- » Can be installed on new and existing conveyors with little effort.
- » Improves hygiene in the conveyor area.

**LUBING**  
POULTRYTEC

LUBING Maschinenfabrik GmbH & Co. KG  
Lubingstraße 6 | 49406 Barnstorf  
Germany

T +49 (0) 54 42 98 79 - 0  
F +49 (0) 54 42 98 79 - 33  
M info@lubing.de

**LUBING.COM**

As of: May 2026 | We reserve the right to make technical changes, further developments and improvements.  
No. 0891-1